

# Product Details LED Panel

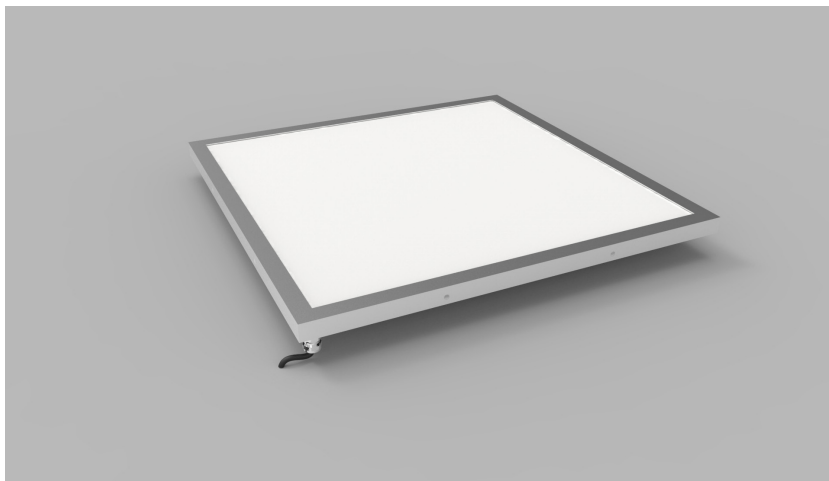

## Specification

Dimensions	Max width - 1500mm Max length - 3000mm Min depth - 20mm
Colour	2.7K/3.0K/3.5K/4.0K/5.0K others on application
Input Voltage	24 Vdc
Power Consumption	Approx - 40W sq/M
IP Rating	IP44 or IP65
Lumen Output	c. 3200 lm/sq metre
Frame Finish	Stainless Steel or RAL to finish
Fixing	Wall or Ceiling

**Order code**  
 LED PANEL-WIDTH-LENGTH-DEPTH-COLOUR-IP-FINISH-FIXING  
 e.g. LED PANEL-XXmm-XXmm-XXmm-2.7K-IP44-SS-MAGNET

WIDTH	LENGTH	DEPTH	COLOUR	IP	FINISH	FIXING
XXmm	XXmm	XXmm	2.7K	IP44	SS	Wall
			3.0K	IP65	RAL	Ceiling
			3.5K			
			4.0K			
			5.0K			

**Drivers**  
 non-dimmable power supplies:  
 1-10V /DALI/DMX dimmable power supplies to be ordered seperately

Please call our sales team who will make sure specification suits application  
 LED Panel by The Light Lab



## Fixing Methods

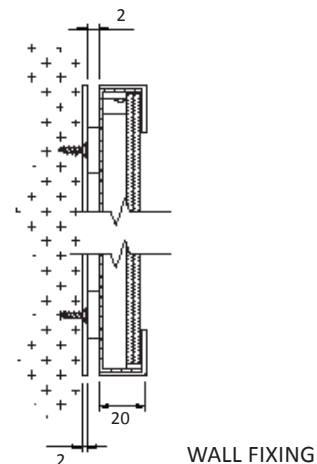

WALL FIXING

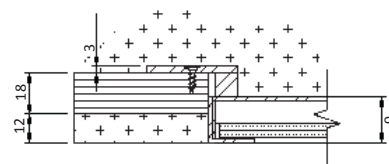

CEILING FIXING

## Photometric Info

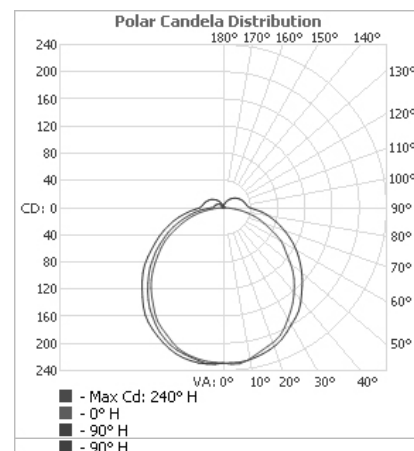

The Light Lab  
 22 Holywell Row  
 London EC2A 4JB  
 United Kingdom  
 +44 (0) 207 278 2678  
 @thelightlabtd  
 www.thelightlab.com